

GATE ARMS+

FOLDARM180

LIFTMASTER MEGA ARM SERIES

INSTALL MANUAL

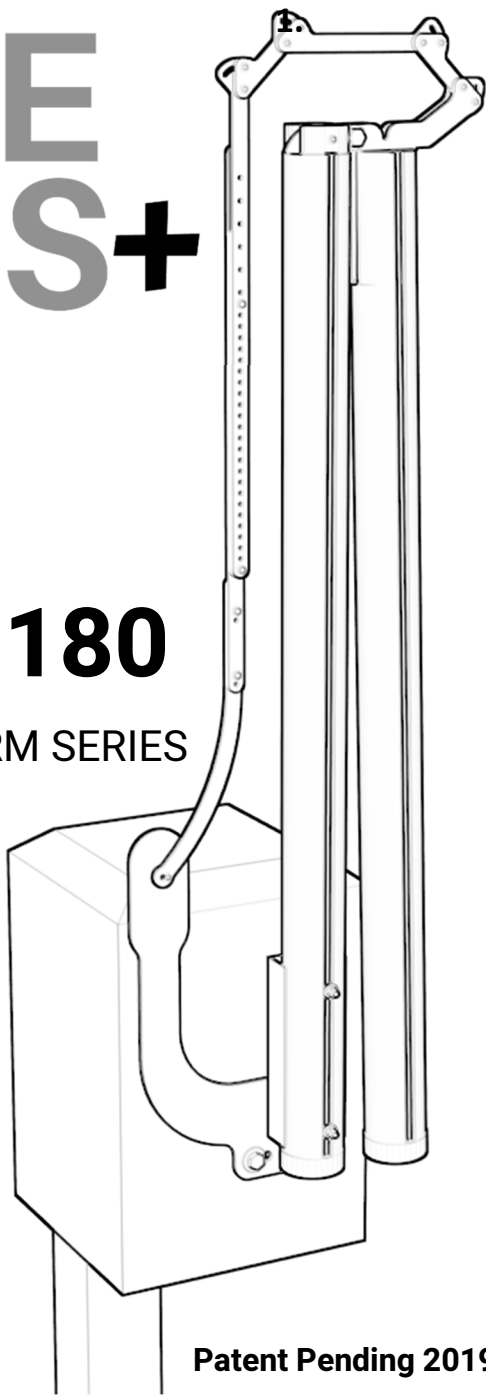

Patent Pending 2019

IMPORTANT SAFETY INFORMATION



IMPORTANT

Please read all instructions and safety information prior to attempting installation.

Always disconnect 110V and 12V power from gate operator equipment prior to touching any wiring or installing anything. Serious injury could occur if power is not disconnected prior to installation.

BE HIGHLY CAUTIOUS OF OVERHEAD POWER LINES!

Ask for assistance from another person to install gate arms. Removal and replacement of the gate arm pole is much simpler with two people.

Always use appropriate PPE during installation including safety glasses, gloves and hearing protection as needed.

Install as directed. GateArms+ LED Barrier Arms and LED Controllers are intended for use as described herein and by the product literature available for download at www.GateArms.com

Any misuse, alteration, or modification of GateArms+ branded products beyond what is described in the available product literature will void all warranties.

1. UNBOX-GET ORGANIZED

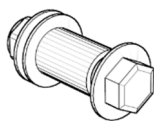

[3x] Offset Plate Bolt Kit

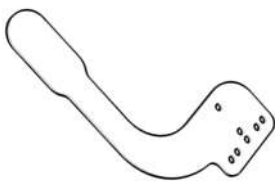

[1x] Offset Plate

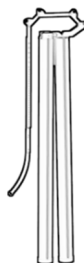

[1x] Articulating Arm Kit

Tools Needed (not included):



1/4" Drill Bit



1/2" Drill Bit

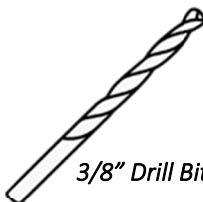

3/8" Drill Bit

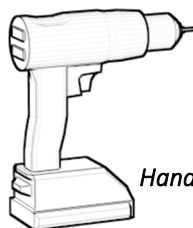

Hand Drill



Measuring Tape



Level Tool

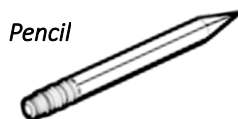

Pencil

NOTE: First time installations will require an INSTKIT-GATE, (not included)

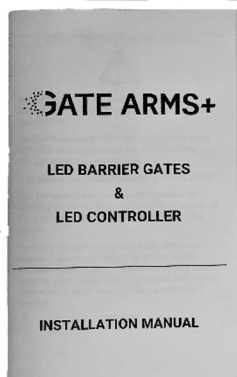

2.REMOVE EXISTING ARM

Is another brand of articulating arm installed?

If yes, remove it now.

It should look like this.

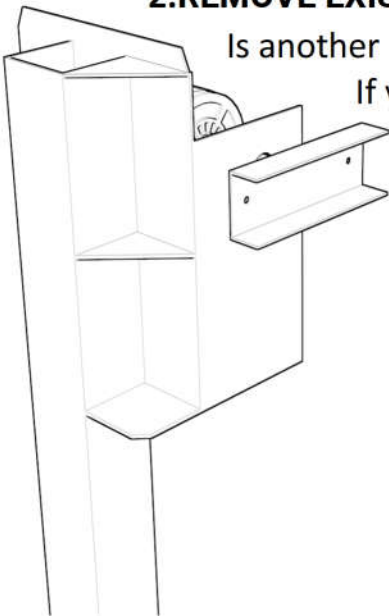

3. MARK & DRILL A HOLE 3" BELOW MOTOR SHAFT

3.1 Make a mark 3" below the center of the motor shaft. If there is a problem using that spot,

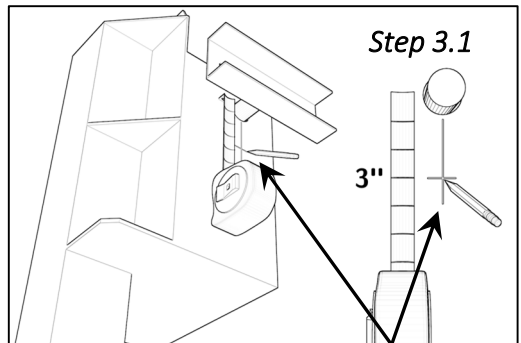

you can make your mark between 2" to 3 ½" below the center of the motor shaft.

3.2 Drill a ½" hole at the site of the mark, being careful not to damage anything on the inside of the operator.

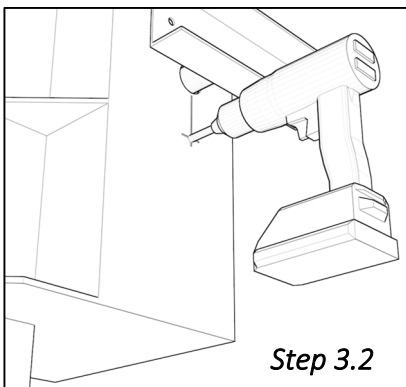

4. POSITION THE OFFSET PLATE

Place offset plate on operator with the top hole over your new hole.

- The curved neck should be facing away from traffic.
- For mounting purposes, we recommend using the holes indicated in Figure 1. If those holes will not work for you, you can also use the layout shown in Figure 2.

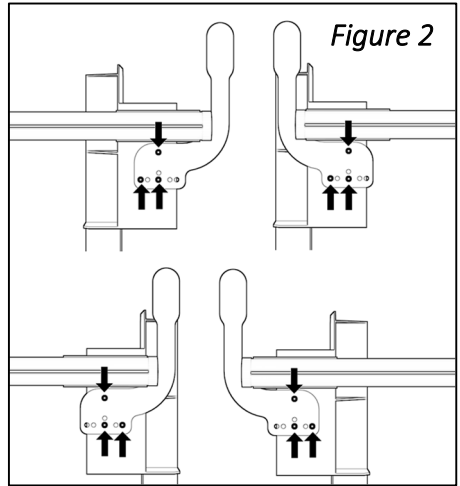
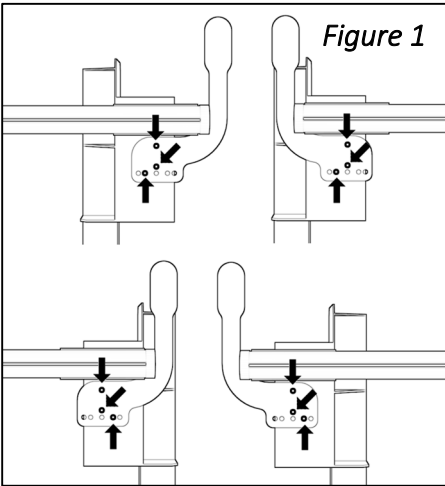

- Use a pencil or marker to mark where you will drill, see Figure 3.
- Use a level to make everything straight.

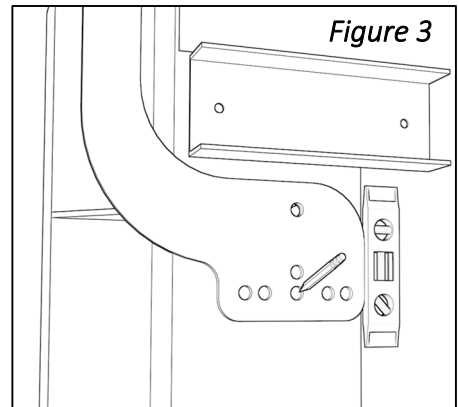

5. DRILL REMAINING TWO HOLES.

- Drill out the holes you marked in the previous step.

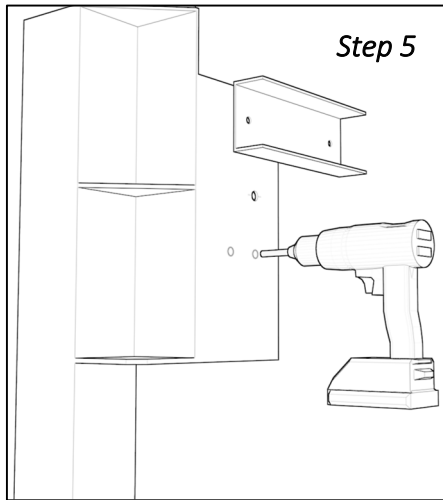

6. INSTALL THE 3 OFFSET PLATE BOLTS

NOTE: If the hole you made is not aligned with the offset plate, DO NOT force the bolt into the hole! Make the hole bigger or make a new hole.

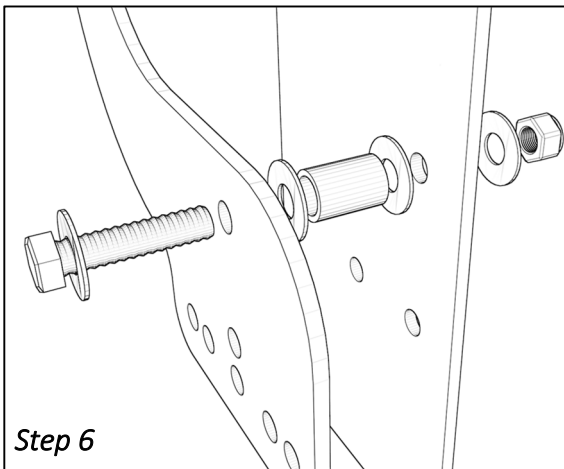

7. INSERT ARM BOLTS & WASHERS THROUGH BRACKET

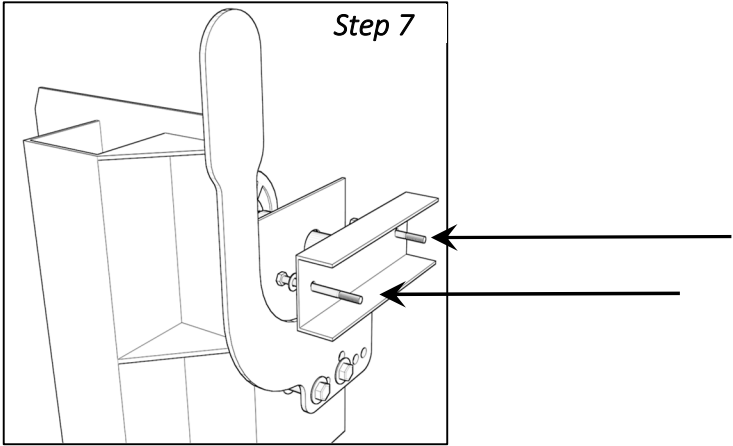

NOTE: The next few steps will require assistance.

8. INSTALL BARRIER ARM ONTO BRACKET

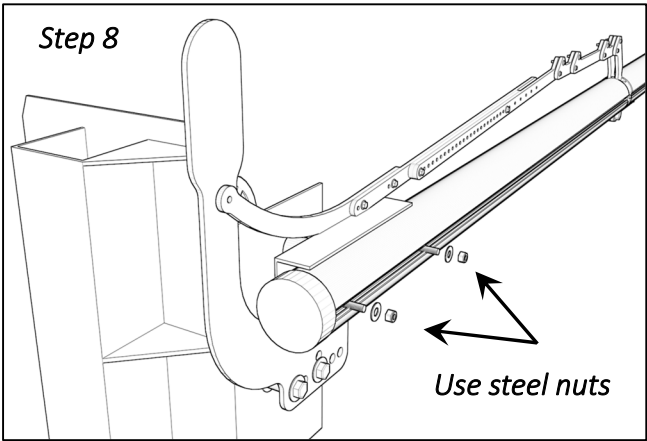

NOTE: Use steel nuts on arm bracket bolts.

9. MAKE VERTICAL MARK ON OFFSET PLATE

With a helper holding the outer arm up a little higher than the horizontal position,

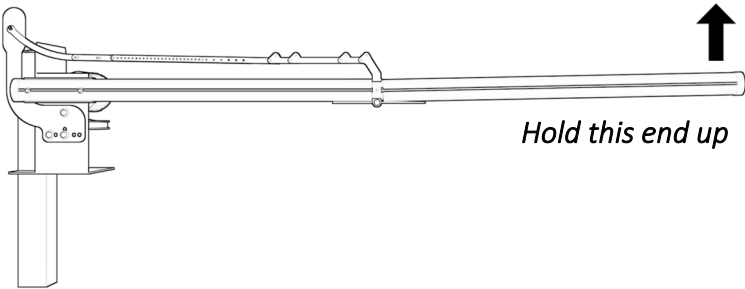

make a vertical mark on the offset plate with a pencil through the hole of the curved end of the arm's linkage as shown below.

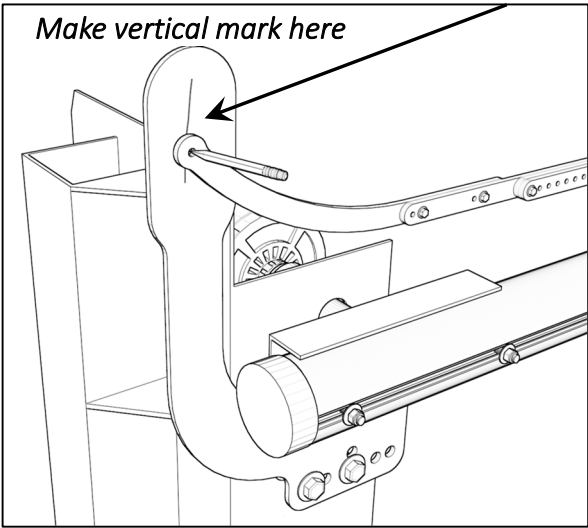

10. RAISE BARRIER ARM UP

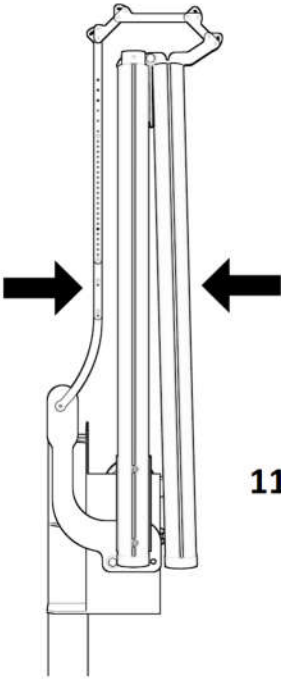

Step 10

- Open the arm fully. Help the barrier arm while it goes up.
- Gently squeeze the outer arm and the transmission system together.

11. MAKE HORIZONTAL MARK ON OFFSET PLATE

While gently squeezing the arm segments together, make another mark on the offset plate with a pencil, this time horizontally.

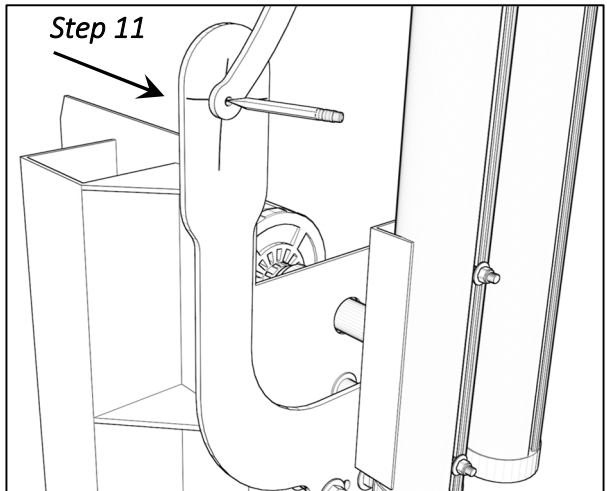

12.DRILL HOLE IN OFFSET PLATE

Using a 3/8” drill bit, make a hole at the intersection of the two pencil marks.

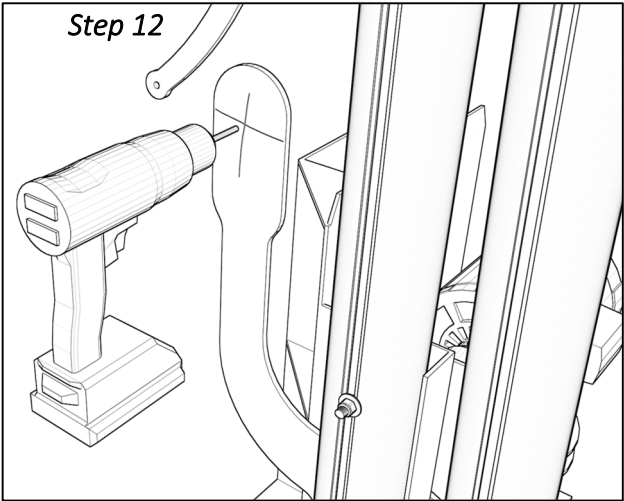

13.INSTALL THE CURVED END OF THE ARM LINKAGE ONTO THE OFFSET PLATE AS SHOWN BELOW.

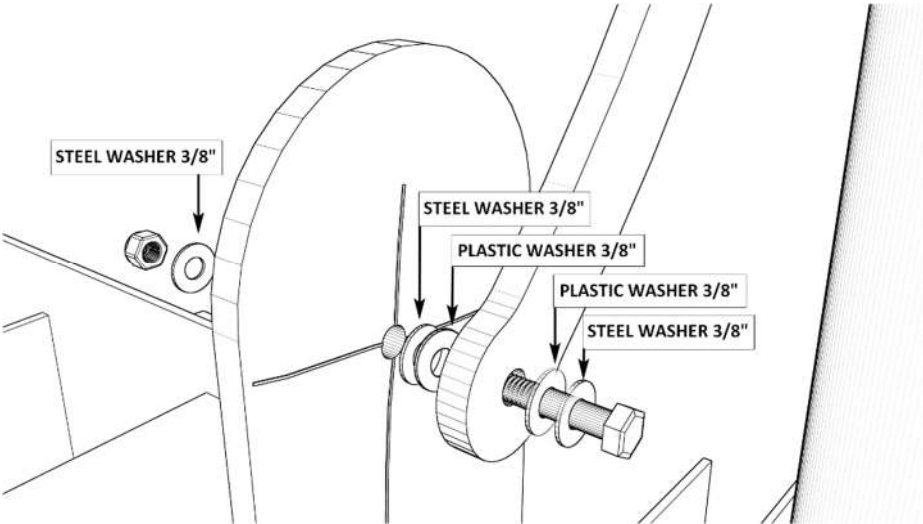

14.INSTALL ADJUSTMENTS: FIX WOBBLING

- 14.1 To improve wobble in the vertical position, carefully tighten this screw.

NOTE: This must not be too tight or the arm segments will stick together when open. This could damage these parts.

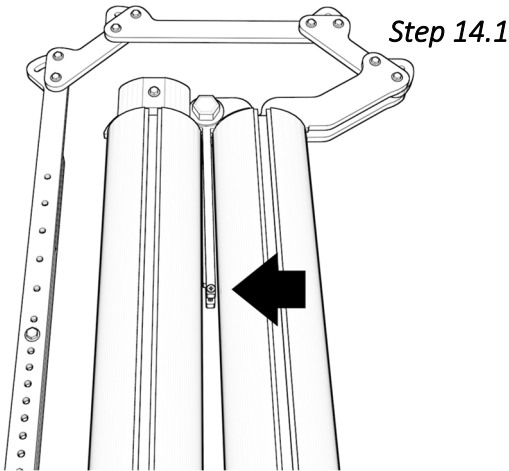

- 14.2 To improve wobble in the horizontal position, carefully tighten the bolt indicated here.

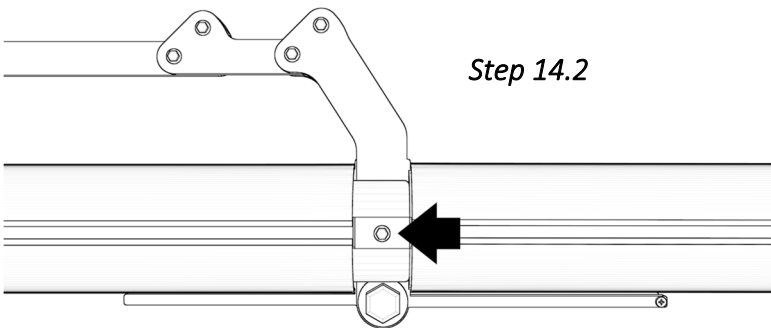

NOTE: This must not be too tight or it may interfere with the elbow motion or cause excess wear.

15.LENGTH ADJUSTMENTS

- Your arm should be perfectly horizontal when down. Is your arm sagging? If so, you must tighten the arm.
- To make quick adjustments, loosen the arm bolts in the bracket and slide the arm left or right to tighten or loosen.
- You can make fine adjustments in $\frac{1}{16}$ " increments by changing the position of some bolts. See the next few pages for instructions.

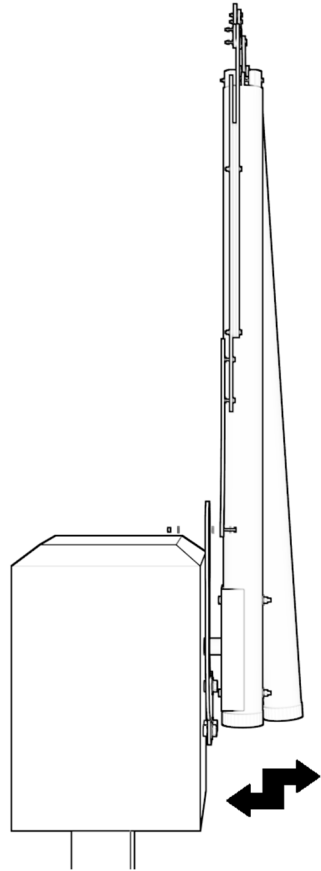

INSTALL ADJUSTMENTS: TIGHTEN BY 1/16"

Adjust the transmission bolts like this on a **4ft** arm.

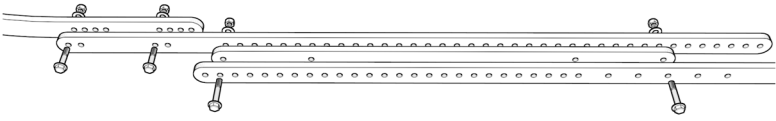

Adjust the transmission bolts like this on a **5ft** arm.

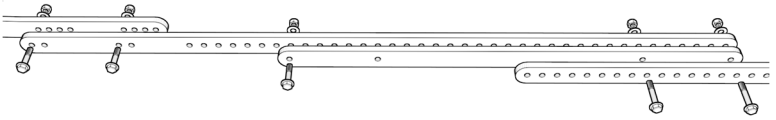

Adjust the transmission bolts like this on a **6ft** arm.

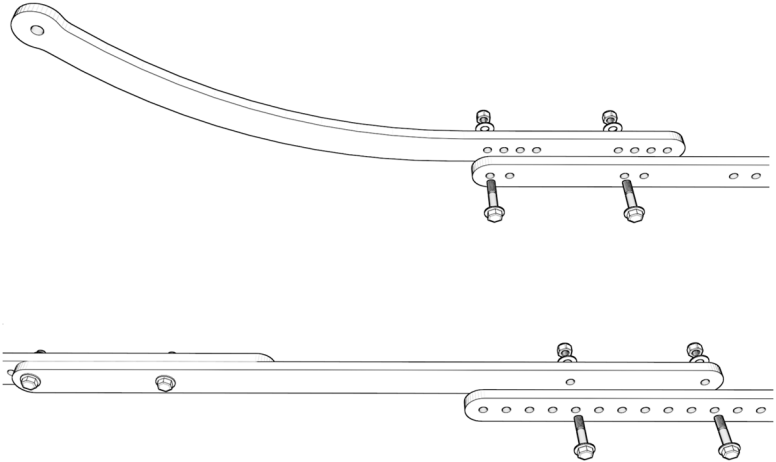

INSTALL ADJUSTMENTS: TIGHTEN BY 1/8"

Adjust the transmission bolts like this on a **4ft** arm.

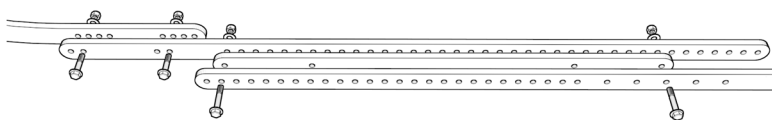

Adjust the transmission bolts like this on a **5ft** arm.

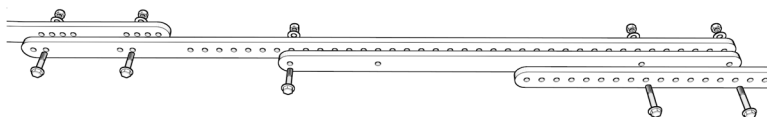

Adjust the transmission bolts like this on a **6ft** arm.

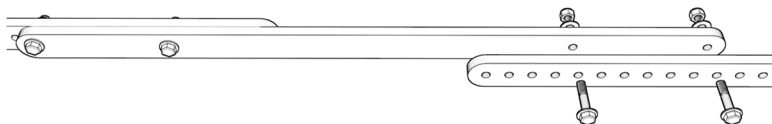
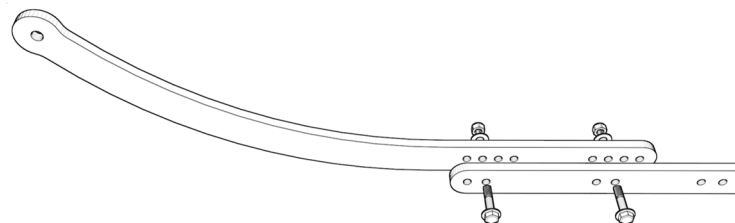

INSTALL ADJUSTMENTS: TIGHTEN BY 3/16"

Adjust the transmission bolts like this on a **4ft** arm.

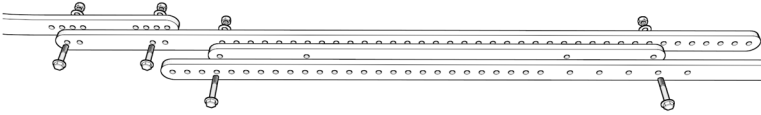

Adjust the transmission bolts like this on a **5ft** arm.

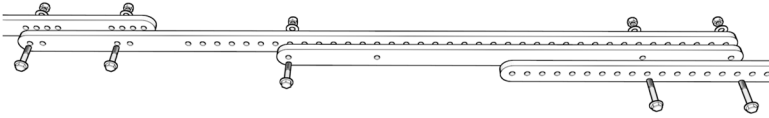

Adjust the transmission bolts like this on a **6ft** arm.

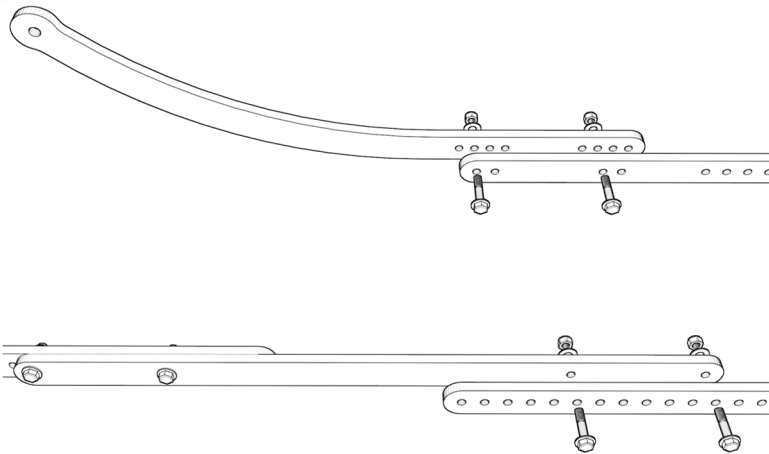

INSTALL ADJUSTMENTS: TIGHTEN BY 1/4"

Adjust the transmission bolts like this on a **4ft** arm.

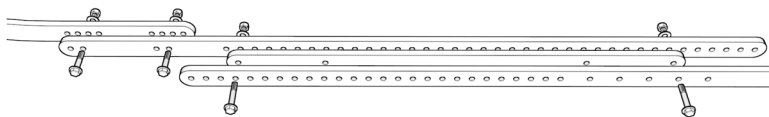

Adjust the transmission bolts like this on a **5ft** arm.

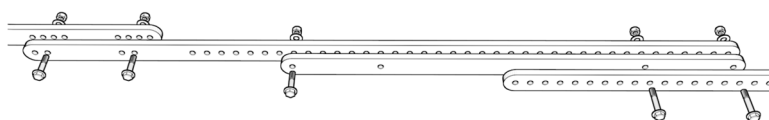

Adjust the transmission bolts like this on a **6ft** arm.

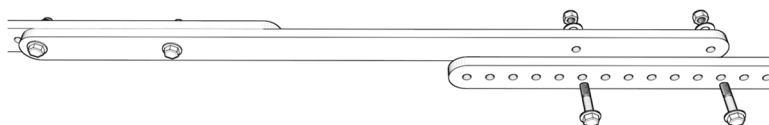
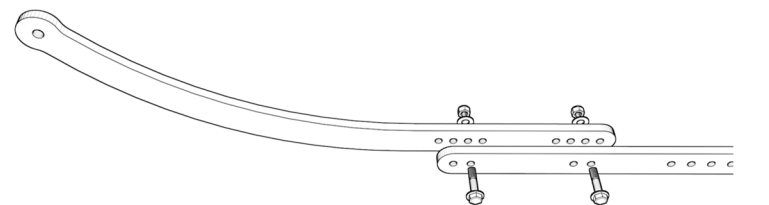

INSTALL ADJUSTMENTS: TIGHTEN BY $\frac{5}{16}$ "

Adjust the transmission bolts like this on a **4ft** arm.

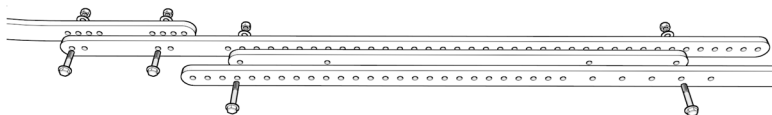

Adjust the transmission bolts like this on a **5ft** arm.

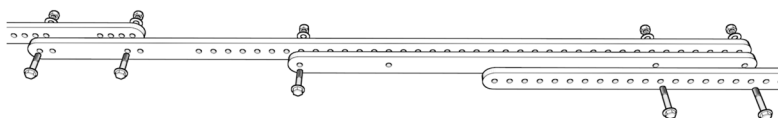

Adjust the transmission bolts like this on a **6ft** arm.

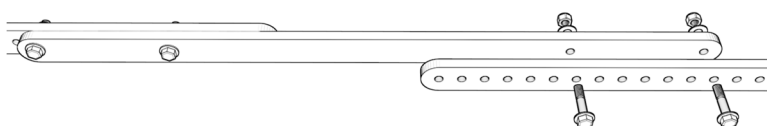
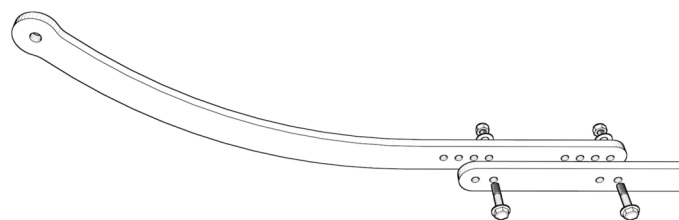

INSTALL ADJUSTMENTS: TIGHTEN BY 3/8"

Adjust the transmission bolts like this on a **4ft** arm.

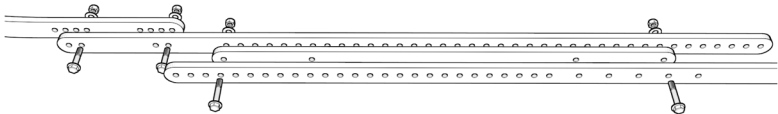

Adjust the transmission bolts like this on a **5ft** arm.

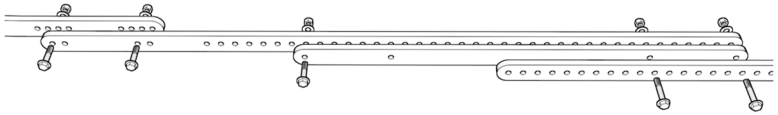

Adjust the transmission bolts like this on a **6ft** arm.

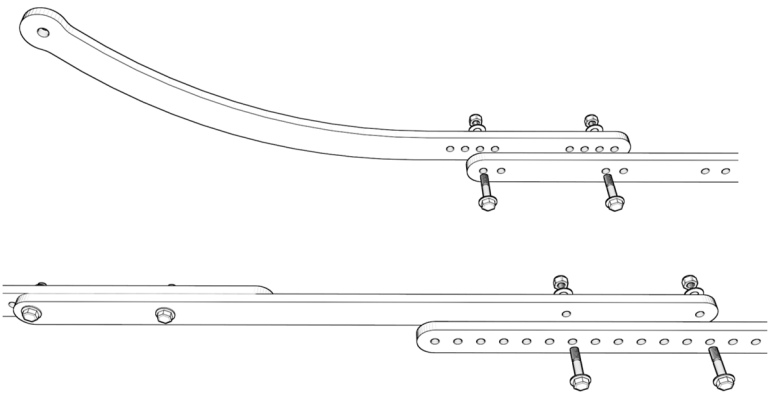

INSTALL ADJUSTMENTS: TIGHTEN BY **7/16"**

Adjust the transmission bolts like this on a **4ft** arm.

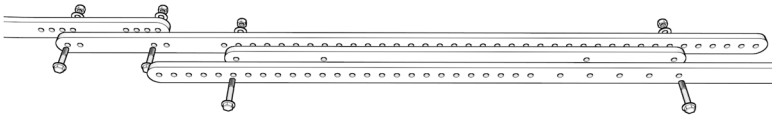

Adjust the transmission bolts like this on a **5ft** arm.

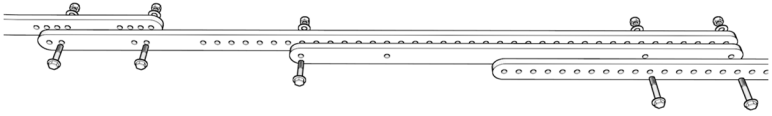

Adjust the transmission bolts like this on a **6ft** arm.

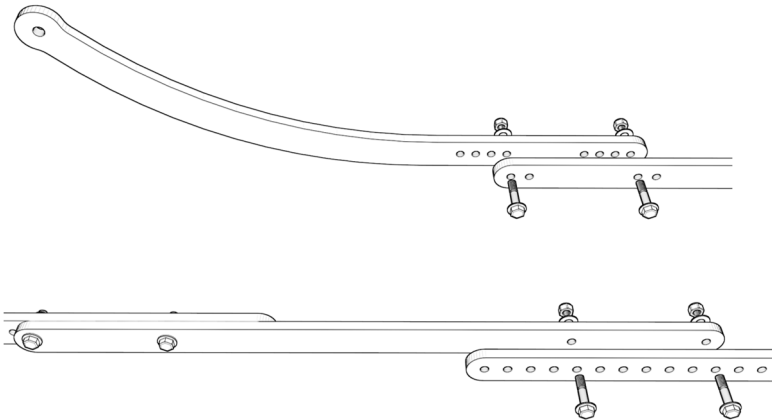

www.GateArms.com
support@GateArms.com
786-339-9840

Patent Pending
© 2020 Gate Arms+
All Rights Reserved